

NOTE: This instruction sheet is for informational purposes only. Your working environment may differ from what is shown in the pictures. Please determine the location of wiring and plumbing before you begin. It is your responsibility to ensure proper installation and, if in doubt, contact customer service. While our products are designed for homeowner installation, you assume all risk associated with the installation process. You may view Installation Videos at <https://closetvids.com>

Unpacking Your Shipment



STOP!



Watch the video at:
www.closetvids.com

FASTENERS

These are the fasteners used in the assembly of Perfect Spaces Storage Systems:



Drawer Face Screw



Wood Screws
(1¼", 2", 3")



Rafix Connector Stud



Sharpie
(½" & ¾")



Shelf Pin



Pan Head Screw
(⅝")



EZ Anchor



L-Bracket



Mending Plate



Euro Screws
(Short / Long)



Breakaway Screws (Gold / Silver)

When purchasing your first closet you will receive a supply of fasteners adequate to complete the installation of your storage system. On your next closet order you will need to include a parachute bag stocked with a supply of fasteners. Please see the "Parachute Bags & Fasteners" guide/video for details.



Need more installation information?

Scan this QR code for detailed procedures and helpful technical tips in our full installation manual.

To open your crate you'll need a power drill equipped with a number 2 square bit.



Once inside you'll find the panels that make up your closet kit stacked on end. If your shipment contains multiple kits then they will be separated by marked divider panels.



**To make your job as easy as possible it is highly recommended that you unpack your shipment in an orderly fashion and when possible, stage the closet components close to where they will be installed.*

The descriptive label attached to each panel will help you identify where it is to be used. On this label we see that this particular panel is a fixed shelf which is a part of room number one it is to be installed on wall number two in section 10.

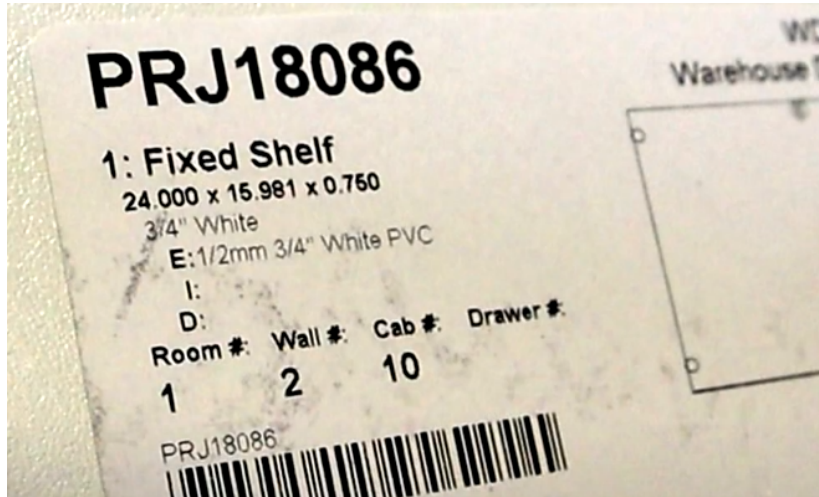

In the overhead view on your elevation schematic, determine the location of wall #2.

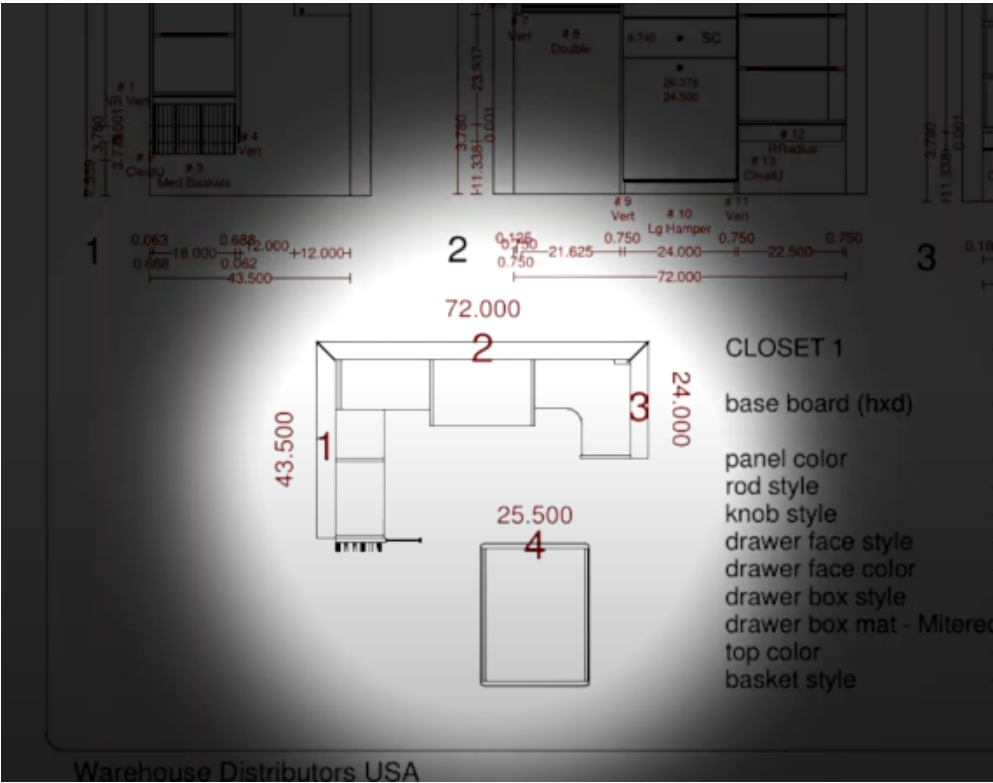

On the detailed view of wall 2, find the section marked 10. This is where the above panel will be used.

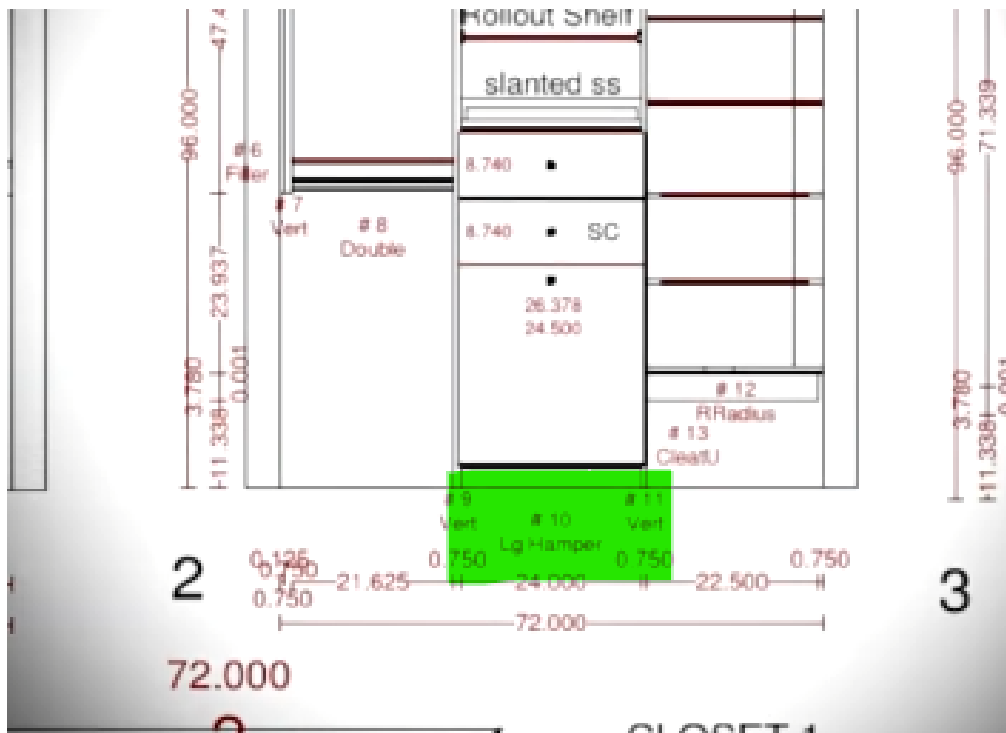

*If you have multiple closets in your order make sure you are looking at the ones specified on the label.

Due to printing constraints sometimes measurements may be difficult to read as some of them may overlap. If this is an issue you can refer to the closet summary page where you will find a list of every component included in your kit along with its measurements and on which wall it is to be installed.

| WDO Install Room | | | | |
|-------------------|-------------------|----------|----------|----------|
| (1) NR Vert | Located on wall 1 | 0.750 W | 71.339 H | 12.000 D |
| (2) CleatU | Located on wall 1 | 19.375 W | 3.780 H | 0.750 D |
| (3) Med Baskets | Located on wall 1 | 18.000 W | 78.898 H | 12.000 D |
| (4) Vert | Located on wall 1 | 0.750 W | 71.339 H | 12.000 D |
| (5) S/O | Located on wall 1 | 12.000 W | 3.000 H | 12.000 D |
| (6) Filler | Located on wall 2 | 0.750 W | 47.402 H | 12.000 D |
| (7) Vert | Located on wall 2 | 0.750 W | 47.402 H | 12.000 D |
| (8) Double | Located on wall 2 | 21.625 W | 47.402 H | 12.000 D |
| (9) Vert | Located on wall 2 | 0.750 W | 86.457 H | 16.000 D |
| (10) Lg Hamper | Located on wall 2 | 24.000 W | 86.457 H | 16.000 D |
| | Located on wall 2 | 0.750 W | 86.457 H | 16.000 D |

Taking just an extra few moments at the beginning of your project to lay everything out orderly and logically will save you a lot time during installation.