

NOTE: This instruction sheet is for informational purposes only. Your working environment may differ from what is shown in the pictures. Please determine the location of wiring and plumbing before you begin. It is your responsibility to ensure proper installation and, if in doubt, contact customer service. While our products are designed for homeowner installation, you assume all risk associated with the installation process. You may view Installation Videos at <https://closetvids.com>

# Shoe Fence Installation



# STOP!



Watch the video at:  
**[www.closetvids.com](https://closetvids.com)**

# FASTENERS

**These are the fasteners used in the assembly of Perfect Spaces Storage Systems:**



Drawer Face Screw



Wood Screws  
(1 1/4", 2", 3")



Rafix Connector Stud



Sharpie  
(1/2" & 3/4")



Shelf Pin



Pan Head Screw  
(5/8")



EZ Anchor



L-Bracket



Mending Plate



Euro Screws  
(Short / Long)



Breakaway Screws (Gold / Silver)

When purchasing your first closet you will receive a supply of fasteners adequate to complete the installation of your storage system. On your next closet order you will need to include a parachute bag stocked with a supply of fasteners. Please see the "Parachute Bags & Fasteners" guide/video for details.



**Need more installation information?**

Scan this QR code for detailed procedures and helpful technical tips in our full installation manual.

Your slanted shelf will have three pre-drilled holes along the front for your shoe fence. Slide the middle support onto the fence, then push the two supports onto the ends.

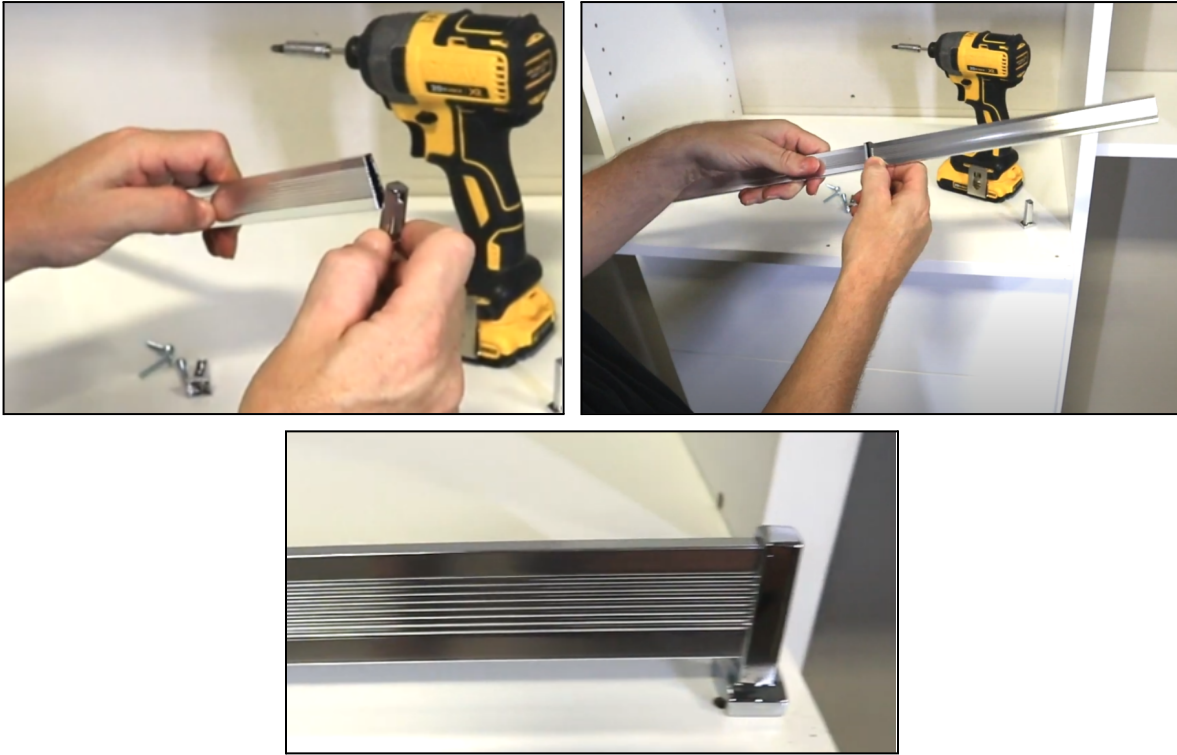

Line the unit up with the pre-drilled holes and then fasten it in place from below using the included screws.



Slanted shoe shelves have Rafx connectors on the rear only and no connectors on the front. They are meant to be used with adjustable shelf pins on the front so that you can achieve your desired degree of tilt. The shelf can also rest on a shelf below.