

NOTE: This instruction sheet is for informational purposes only. Your working environment may differ from what is shown in the pictures. Please determine the location of wiring and plumbing before you begin. It is your responsibility to ensure proper installation and, if in doubt, contact customer service. While our products are designed for homeowner installation, you assume all risk associated with the installation process. You may view Installation Videos at <https://closetvids.com>

Door Installation



STOP!



**Watch the installation video at:
www.closetvids.com**

FASTENERS

These are the fasteners used in the assembly of Perfect Spaces Storage Systems:



Drawer Face Screw



Wood Screws
(1 1/4", 2", 3")



Rafix Connector Stud



Sharpie
(1/2" & 3/4")



Shelf Pin



Pan Head Screw
(5/8")



EZ Anchor



L-Bracket



Mending Plate



Euro Screws
(Short / Long)



Breakaway Screws (Gold / Silver)

When purchasing your first closet you will receive a supply of fasteners adequate to complete the installation of your storage system. On your next closet order you will need to include a parachute bag stocked with a supply of fasteners. Please see the "Parachute Bags & Fasteners" guide/video for details.



Need more installation information?

Scan this QR code for detailed procedures and helpful technical tips in our full installation manual.

**Consult your documentation to confirm you are installing the doors in the correct location.*

Prepare the hinges for installation by attaching the hinge plate to the hinge as shown:

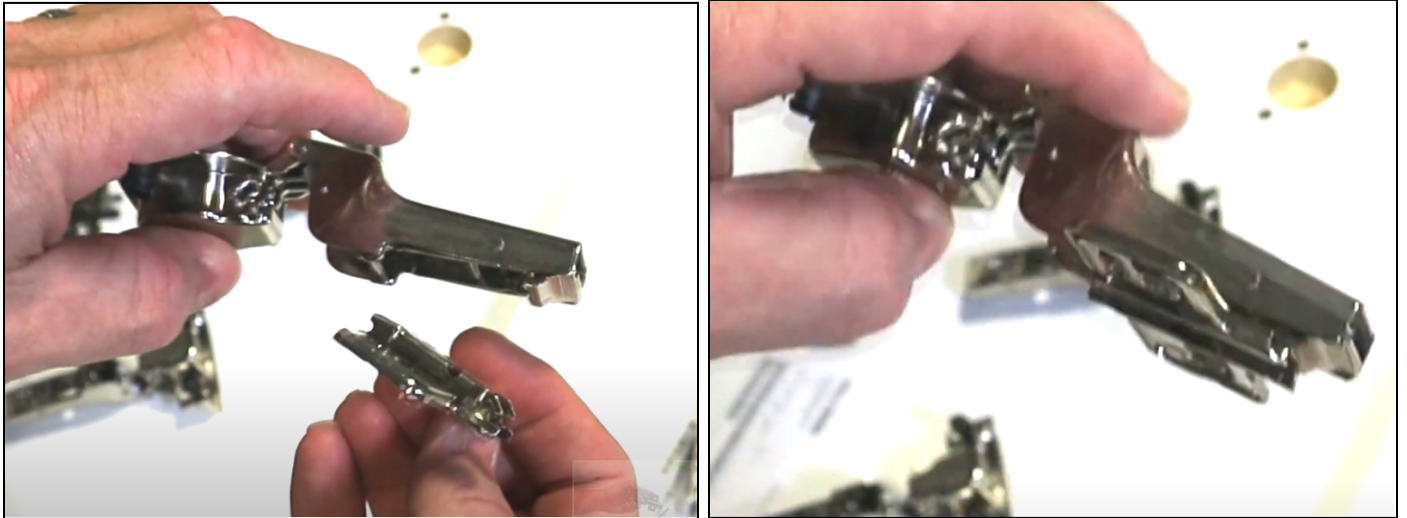

(The plate has an arrow etched in it that will show you the correct orientation)



Press the hinge into the holes on the doors and then press the flap down to lock the hinge into place.

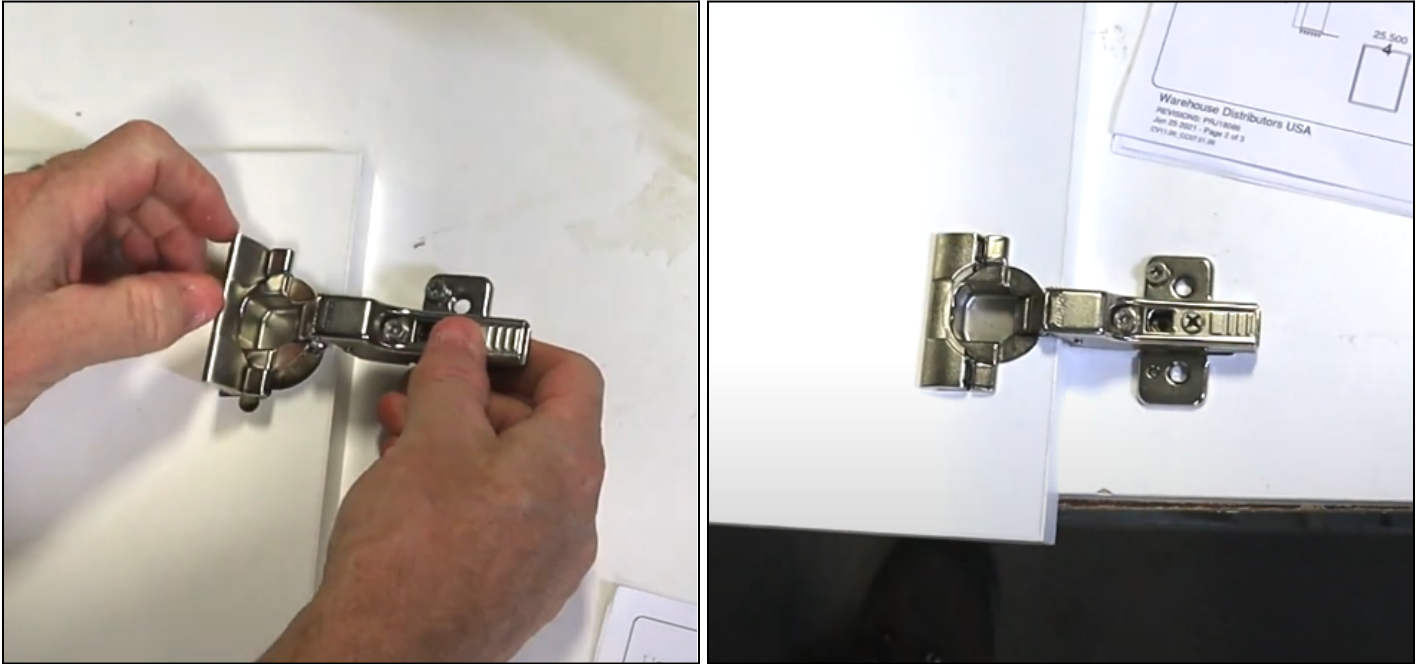

Euro screws will be used in the pre-drilled system holes for attaching the doors to the unit. Be sure to use the long euro screws for door installations since they are stronger.

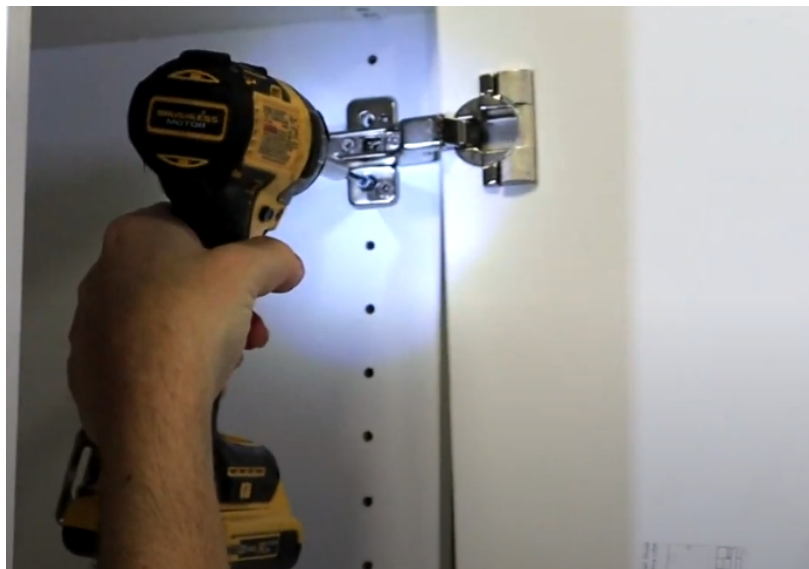

Adjust the doors so that they align properly. Your door hinges have three adjustments:

Up/Down



In/Out

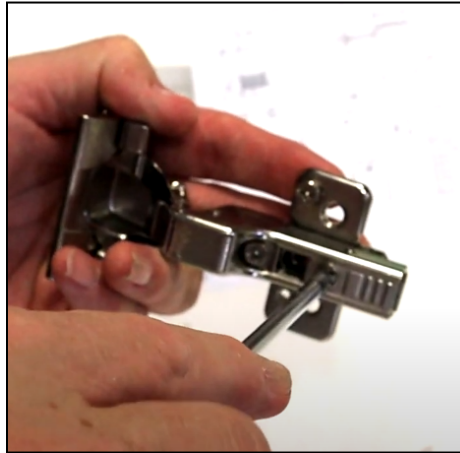

Sideways

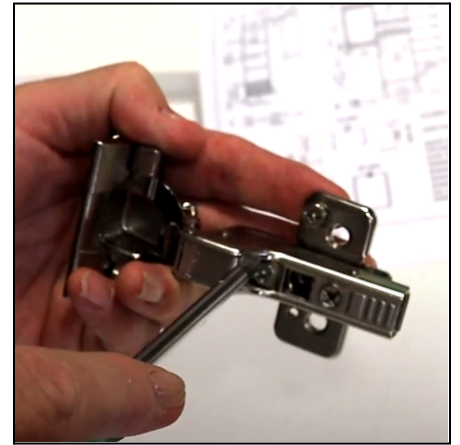

When making your adjustments try to adjust all hinges on a door equally. Use the reveals on the sides, top and the bottom as reference points to help you determine if the door is straight.

